

You have the ideas

We turn them into reality

Developing concrete molds from polyurethane requires a high level of experience and know-how.

We put your ideas into action and into shape by using precisely planned processes.

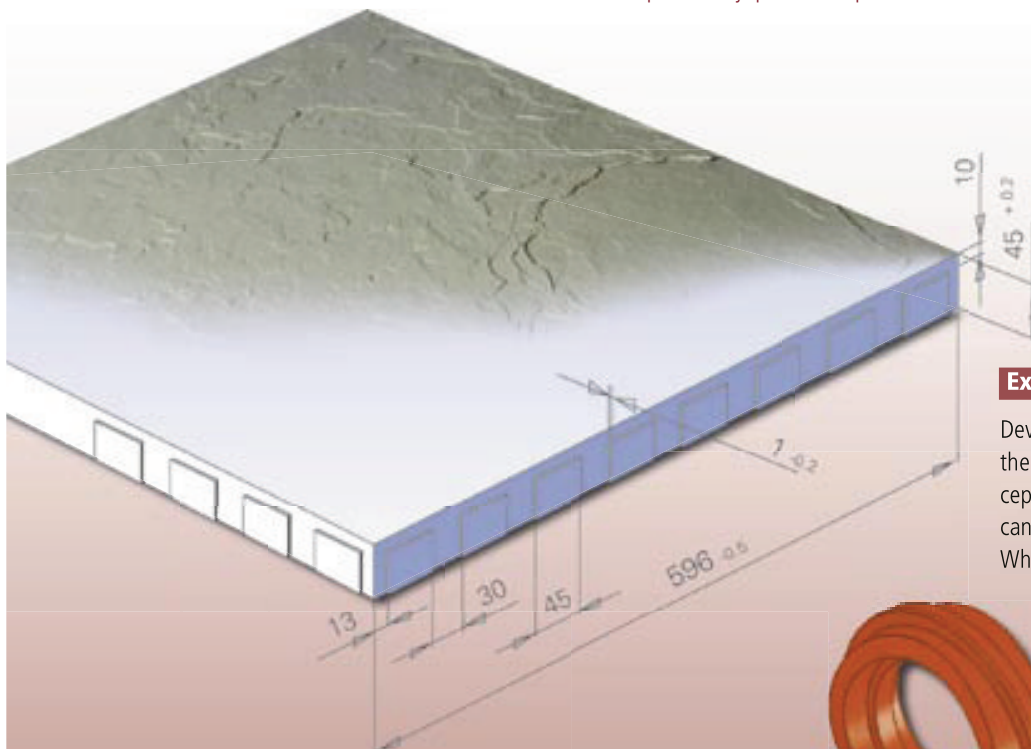

#### Example 1

Development of a polyurethane mold for the production of wetcast slabs with exceptionally high accuracy. This technology can be used for any shape of block. Why not see what we can do for you?

#### Example 2

Development of a two-part mold for the production of a man-hole lining made from polymer concrete.

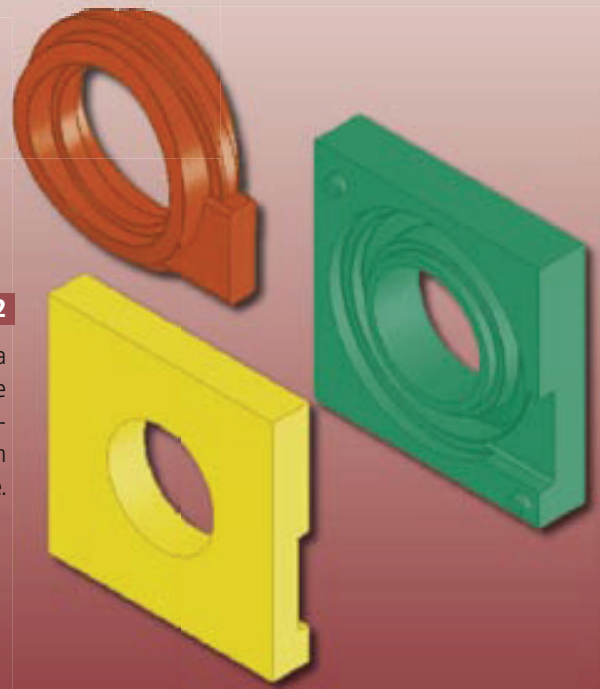

# Accuracy in the mold equals Accuracy in the finished product

Example 1



A solid wooden frame ensures the accurate curing of the product.

Example 2



For larger products a sheet metal case is used. The fittings are especially designed to suit our customer needs.

Example 3



The design of the wall thickness ensures accurate products even without supporting frame.

Example 4

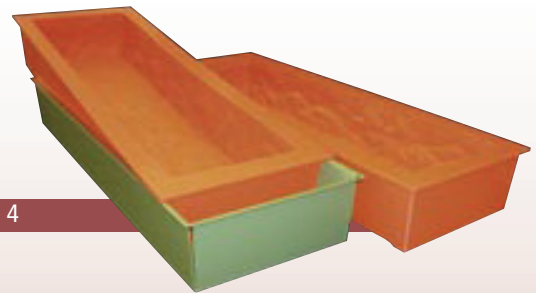

Our polyurethane molds offer unlimited possibilities in respect of size, shape and surface textures. Here you see a large scale mold (weight 35 kg/ 77,2 lbs.) for the production of stepping stones.

Example 5

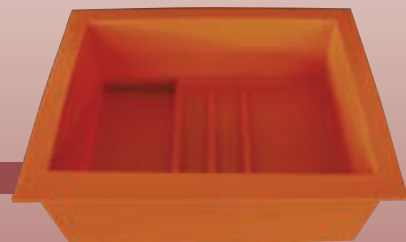

This mold is poured with a material which keeps the dimensions very constant over the service life of the mold. The master tool was made with a five axis CNC milling machine.

Example 6

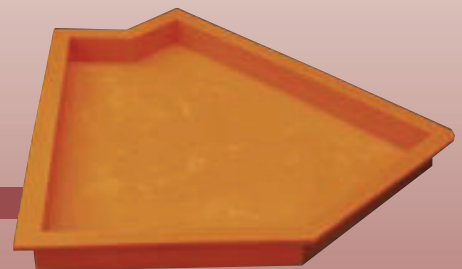

You have the idea, we put them into reality. Even for extraordinary products with a complex shape, we can supply the mold.